

# Hofina Metal Shelf with Wood Accent

## Install Guide

### Required Installation Tools:

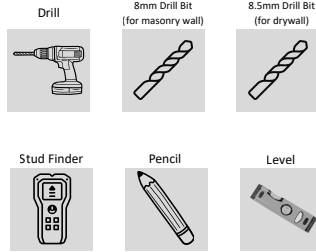

### What's Included:



### Still Need Help?

If you have any questions regarding the installation, please do not hesitate to contact us.

✉ [info@hofina.com](mailto:info@hofina.com)  
 📷 [@hofinashop](https://www.instagram.com/hofinashop)

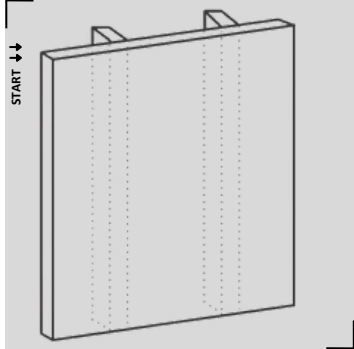

**001** First: Determine your desired location for your shelf.

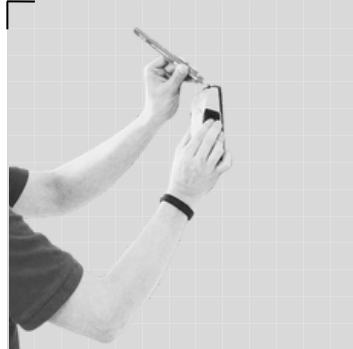

**002** Mark the studs with the help of a pencil and a stud finder.

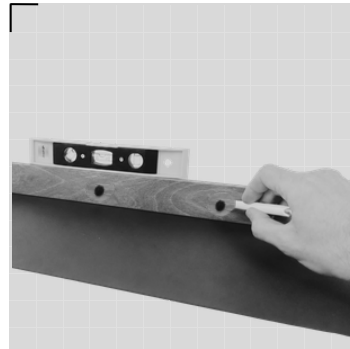

**003** Please ensure the metal shelf is level using a spirit level. Mark the locations of the holes on the shelf and make sure to secure it to at least one stud.

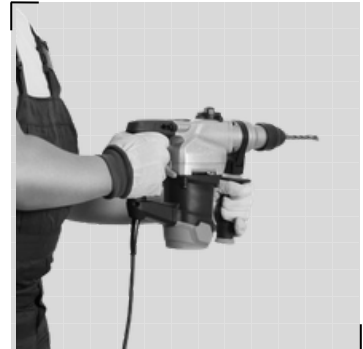

**004** If you are not mounting the metal shelf to a stud, you will need to use wall anchors. Drill holes suitable for your wall type (**drywall: 8.5mm, masonry wall: 8mm**) and insert the anchor.

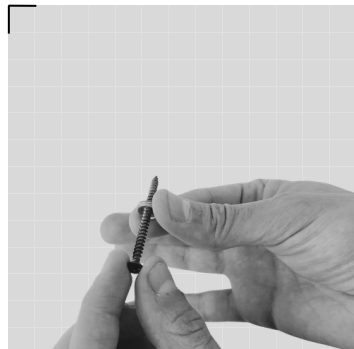

**005** Place the screw through the decorative cap, then prepare for mounting.

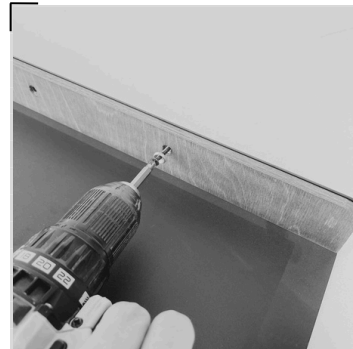

**006** Secure your shelf to the wall using the screws suitable for your wall type.



**007** This is how the screw cover should look after installation.

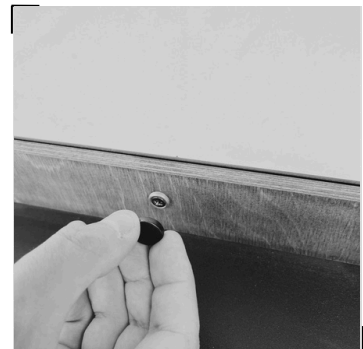

**008** Secure the cover by gently twisting it into place.

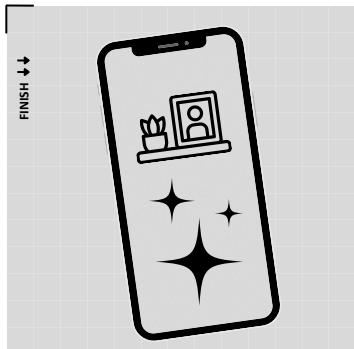

**009** It's time to celebrate you and your project's innate awesomeness! You finished this project and deserve heaps of adulation. Send us a picture on Instagram to: [@hofinashop](https://www.instagram.com/hofinashop). Warning: rad prizes may apply!

## Rad Tips

### ① Studs & Blocking

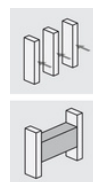

Studs are the vertical 2x4 boards that make up the bones of your walls. They provide solid structure for your shelves to attach to. Blocking is typically added later between studs in the wall for additional support to mount shelves or hook to, and is usually made from 2x4 or 2x6 lumber.

### ② Alternative Use



Your shelf can also be installed in the reverse orientation if preferred. The installation process remains the same for both directions.



**Important:** For safety and optimal results, installation must be carried out by two people.