

Hofina Acrylic Floating Nightstand

Install Guide

Required Installation Tools:

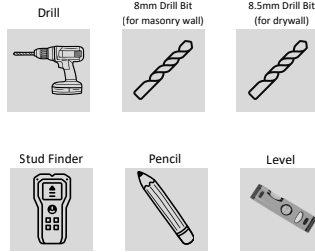

What's Included:



Still Need Help?

If you have any questions regarding the installation, please do not hesitate to contact us.

✉ info@hofina.com
 📷 [@hofinashop](https://www.instagram.com/hofinashop)

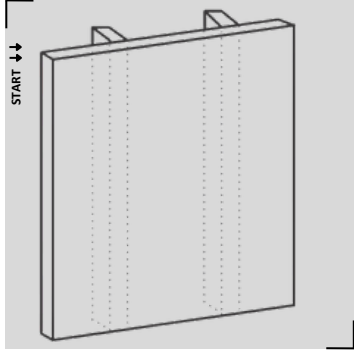

001 First: Determine your desired location for your shelf.

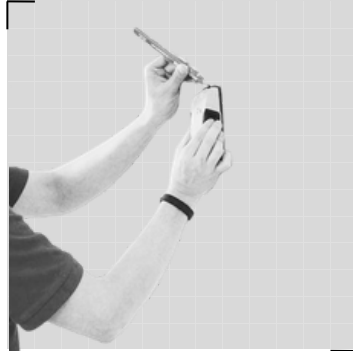

002 Mark the studs with the help of a pencil and a stud finder.

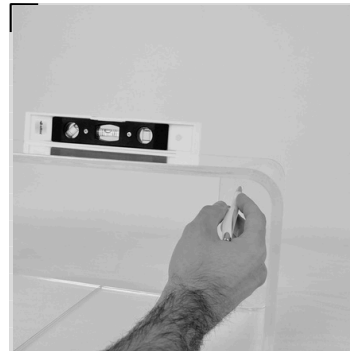

003 Please ensure the nightstand is level using a spirit level. Mark the locations of the holes on the shelf and make sure to secure it to at least one stud.

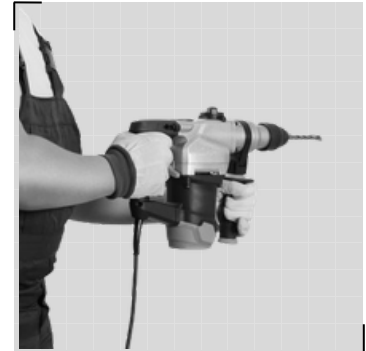

004 If you are not mounting the nightstand to a stud, you will need to use wall anchors. Drill holes suitable for your wall type (**drywall: 8.5mm, masonry wall: 8mm**) and insert the anchor.

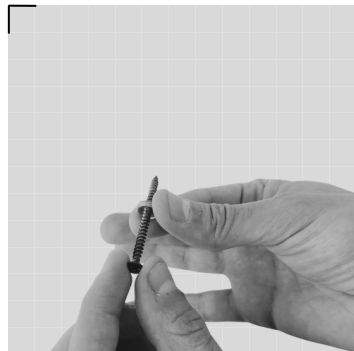

005 Place the screw through the decorative cap, then prepare for mounting.

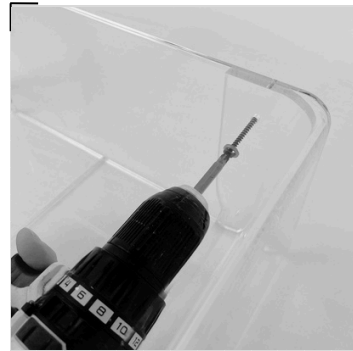

006 Secure your shelf to the wall using the screws suitable for your wall type.

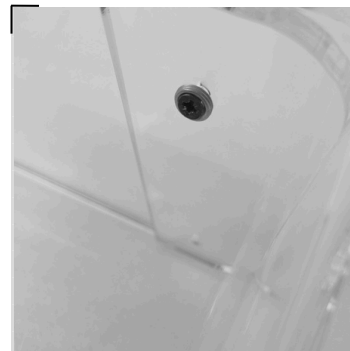

007 This is how the screw cover should look after installation.



008 Secure the cover by gently twisting it into place.

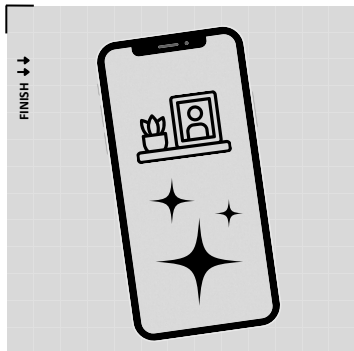

009 It's time to celebrate you and your project's innate awesomeness! You finished this project and deserve heaps of adulation. Send us a picture on Instagram to: [@hofinashop](https://www.instagram.com/hofinashop). Warning: rad prizes may apply!

Rad Tips

1 Studs & Blocking

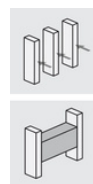

Studs are the vertical 2x4 boards that make up the bones of your walls. They provide solid structure for your nightstands to attach to. Blocking is typically added later between studs in the wall for additional support to mount shelves or hook to, and is usually made from 2x4 or 2x6 lumber.

Hofina



Important: For safety and optimal results, installation must be carried out by two people.